



Building On the
Cornerstone

Ephesians 2:20

Together, we are his house, built on the foundation of the apostles and the prophets. And the cornerstone is Christ Jesus Himself.



BECKY & DAVID ZASTROW, GENERAL CHAIR

I'm excited about the opportunity to live out this God-sized dream of building a new church building and re-unifying the church and school. This is something future generations will benefit from, and it's great to be part of establishing this legacy.

As we embark on this journey, I think about the Trinity members who came before us and led our two prior church building efforts all those years ago. How they also looked towards the future and how those buildings would serve future generations. And how they acted on faith to make it happen.

I pray about the opportunity that has been given to us to build a more current house for God, and I pray that we are wise stewards with the gifts He has given us. As we prepare to build a new house for Him, I pray that He will lead us to make good decisions, that we build Him a house that will allow us to spread His word, teach His people, and have fellowship with one another.

something for future generations

MARK KOSINSKI, CAMPAIGN CABINET

The thought of Trinity Lutheran Church and School in one complex truly makes us one family again, all under the same roof. A new sanctuary will provide much-needed additional space for worship, education and fellowship. More space for fellowship means the ability to comfortably spend time with each other in a space not affected and disrupted by those coming and going to church.

There are many current members who attended school at the Madison location and had Wednesday Chapel in the Chapel area within the sanctuary. I believe that the love and appreciation many of these same members currently hold of our current sanctuary was rooted in the time they spent there as a child. My dream is that our current students will be able to develop that same love, passion and desire for the new sanctuary as they get older.

family all under the same roof



BRETT BLOEBAUM, PRESIDENT OF THE CONGREGATION

Unification will allow our church and school ministries better visibility by actually working together each day. This move will also give the church flexibility to serve more of God's people in more ways, both in the near-term and for many years to come.

working together

JOHN & JOANNE MAITLAND, HONORARY CHAIRS

It is exciting to see our church family have a vision on how we can better serve our Lord. By having extended facilities our mission to share the forgiveness and love of the resurrected Christ and to make disciples can be delivered. We show our faith in making this commitment for the Lord.

One person cannot build a church but a congregation can.

Through our prayers and dedication this will happen.

faith in making this commitment



Greetings in the name of our Lord, Jesus Christ

finished to serve the needs of our growing enrollment in a facility to serve in the 21st century. Now it is time to re-unite our church with our school. I am incredibly excited about our pastors just walking down the hall to the school, holding chapel in a sanctuary, and bringing Christ to our non-member school families with our new church being right there connected to the school.

Our ancestors in Trinity Lutheran met the challenge to build new churches at some difficult times in the history of the area or even in the United States. As a people of faith we gladly meet these challenges that may come to plant the seeds for new growth.

Please study these materials closely and pray about your part in this great effort. The sacrifices of many from our past have given us so much today. Let us continue their benevolence.

In Christ,

PASTOR TOM WIRSING
SENIOR PASTOR



Folks,

As the people of Trinity Lutheran Church and School we are called to share the forgiveness and love of the resurrected Christ and make disciples. Fulfilling this mission is a challenge in a world that can be hostile to our message of Christ's saving power, hope and love. For over 160 years Trinity Lutheran has carried out this mission and I am humbled by the overwhelming generosity of so many to our community at large.

In our past we have been called upon to build a new house for our congregation so that we may continue to carry out our mission. With Christ as our cornerstone, each time the members of our congregation were called upon to rebuild or build our sanctuary they have responded with overwhelming generosity. Now it is our turn to provide a new home for our church family.

2003 was an exciting time as our new school was

Campaign Prayer

Gracious God, you call the people of Trinity Lutheran to ventures with an unknown end and many perils along the journey. We know Your hand will lead us to complete a new sanctuary with all Your people in mind. You have led and empowered us before in similar journeys to successful ends. Send your Holy Spirit upon us as we are building on the cornerstone of Christ. Give us courage, generous hearts and unity of purpose as we build Your house to carry out the work of the Gospel for the sake of Jesus Christ, our Savior and Lord. Amen.

*With the faith
of a mustard seed ...*
(Matthew 17:20)

1863

Our ancestors in faith purchased another church building and moved it to Main and Olive and dedicated it to the Lord in June.

1884

By the early 1880s the congregation had outgrown its church. The members of Trinity Lutheran built a beautiful new sanctuary again at Main and Olive Streets.



1892

Both schools were consolidated and a new school was constructed on our current (South Madison St.) site.



1858

The Rev. Friedrich Ruff and Trinity Lutheran began in the old McLean County Court House. Our rich school tradition began as well with classes held during the week taught by Trinity's first three pastors.

1867

The congregation was officially received as a member of the German Evangelical Lutheran Synod, which is known today as the Lutheran Church—Missouri Synod.

Trinity continued to add to its membership and the school grew to over 100 pupils by the early 1870s. This precipitated Trinity Lutheran to build two schools in 1873, one located on the south side of Bloomington at Lincoln and Main Streets, and one located on the west side of Bloomington on W. Chestnut St.

1941

By the mid-'30s, the congregation realized the need for a parish hall and improved school facilities on our current (South Madison) and both were completed in March 1941.

1955

Our new unified church and school building dedicated in February 1955.



1958

We celebrated a century of faith in our Trinity Lutheran family.

2003

We replaced our 60-year-old school with a new facility on our Hamilton Road property. We also made some improvements to our current church site with a new covered drop area, elevator, and better lighting.



2008

Trinity Lutheran celebrated its 150th year serving the people of Bloomington, IL and the surrounding communities. By God's grace, we continue to serve!



2017

The congregation votes to build a new sanctuary on the Hamilton Road campus and re-unite with our school.

Our Need

Since our school opened on Hamilton Road in 2003, our resources have been divided between two campuses. This division limits our community's chance to collaborate as a staff and faith family. Additionally, our students miss out on the gift of chapel held in an actual sanctuary. School families without a worship home currently do not have the opportunity to witness our great work as a faith family every day. Unifying the school and church will improve our entire community and better support our students.

As our ministries have adapted to a changing culture, our current facilities have not. We have a growing need for larger gathering space, for a nursery, cry room, and nursing space that better supports young families in worship, and bathrooms more accessibly located on the main level. The new facilities will be warm and welcoming for many generations. Our current sanctuary home has given us so many memorable moments for our family in Christ. However, it is now time for us to build a new church home for future generations.

Galatians 3:28 tells us that: "...you are all one in Christ." So now we look forward to constructing a church home where all are welcome. Our sanctuary will be a place where we can find respite from the challenges found in the world today and a place where we can come together in Christ to better equip ourselves to carry out the Great Commission of bringing the good news of Jesus Christ to all the world. As we are told in Matthew 9:37 "...the harvest is plentiful, but the laborers are few."

It will truly be a sanctuary where we can find strength to battle the troubles of this world, where many memories as a faith family will be made, and where our wonderful faith tradition will continue.

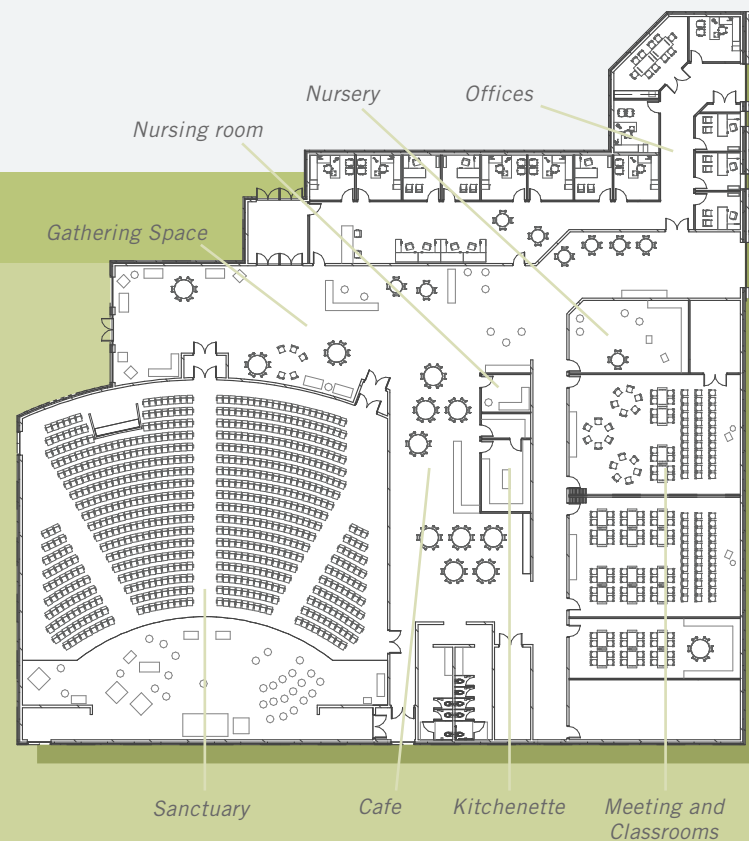

PHASE 1

Will give us the space to accommodate about 750 people in worship and allow us to continue to offer three Sunday services. An expanded fellowship space with new, larger meeting areas and a café will enable us to grow as a family in Christ. Modern communication tools, state-of-the-art audio and video capabilities, and well-designed acoustics will be in our new home. Our unified church and school staff will have the power to advance our mission with new and expanded administrative space. Plenty of convenient parking will be available as we will be able to accommodate over 250 vehicles. Finally, we have prepared for continued growth in our new sanctuary by designing a structure that can accommodate a new balcony when the time comes for that need.

Methods of Giving

There are many ways to contribute and support the capital campaign. A pledge is a commitment made in good faith, but it is not legally binding. Most donors fulfill their pledge over a three-year period making it easier to maximize their support.

CASH/CHECK

The most common method of a gift is to contribute cash/check. You may benefit from such gifts with a charitable deduction on your tax return.

CREDIT/DEBIT CARD/BANK WITHDRAWAL

Through our electronic giving program, you can set up your pledge to be charged to your credit card or automatically withdrawn from your bank account. Visit trinluth.org and click on the "Campaign" tab and choose "Give Online" to set up your donation.

REAL ESTATE

Gifts of property entitle a donor to an income tax deduction equal to the full market value with no tax on any capital gains.

SECURITIES

Charitable gifts of stocks, bonds, or mutual funds that have appreciated offer special tax advantages and can be a great way to provide a significant gift to Trinity Lutheran Church. Contact Scott Hoeft, Trinity business manager, for assistance with these types of gifts.

LIFE INSURANCE

You can donate an old policy by simply naming Trinity Lutheran Church as the owner and beneficiary. Or you can consider donating a new policy.

PLANNED GIFT

Planned giving is the process of carefully selecting the best method and assets for making a charitable gift. Such a gift can enable you to take full advantage of the tax laws to accomplish your financial and charitable goals. A bequest contained in your will is the most common form of planned giving.

CORPORATE MATCHING GIFTS

A matching gift program provided through your employer or board membership may allow you to increase the value of your gift. Many companies match charitable gifts of employees, retirees or board members.

NOTE: Do not interpret this information as legal advice. Please consult with your own qualified professional adviser for specific recommendations.

TOTAL GIFT	INITIAL 10% DONATION	BALANCE	MONTHLY	QUARTERLY	SEMIANNUAL	ANNUAL
\$75,000	\$7,500	\$67,500	\$1,875	\$5,625	\$11,250	\$22,500
\$50,000	\$5,000	\$45,000	\$1,250	\$3,750	\$7,500	\$15,000
\$30,000	\$3,000	\$27,000	\$750	\$2,250	\$4,500	\$9,000
\$15,000	\$1,500	\$13,500	\$375	\$1,125	\$2,250	\$4,500
\$10,000	\$1,000	\$9,000	\$250	\$750	\$1,500	\$3,000
\$7,200	\$720	\$6,480	\$180	\$540	\$1,080	\$2,160
\$6,000	\$600	\$5,400	\$150	\$450	\$900	\$1,800
\$5,400	\$540	\$4,860	\$135	\$405	\$810	\$1,620
\$3,600	\$360	\$3,240	\$90	\$270	\$540	\$1,080
\$1,800	\$180	\$1,620	\$45	\$135	\$270	\$540



CAMPAIGN LEADERSHIP

Pastoral Staff

Pastor Tom Wirsing
Pastor Billy Newell
Pastor Terry Strom
Pastor Chuck Bahn

General Chairs

Gerald & Jayme Thompson
David & Becky Zastrow

Honorary Chairs

John & Chris Kibler
Senator John & Joanne Maitland

Development Counsel

Steier Group



Trinity Lutheran
801 S. Madison St.
Bloomington, IL 61701
309.828.6265
www.trinluth.org